

DC coreless motor 6mm / 直流空心杯馬達 6mm

Ø6mm, metal brushes/Ø6mm, 金屬電刷

Outline Drawing/外形圖

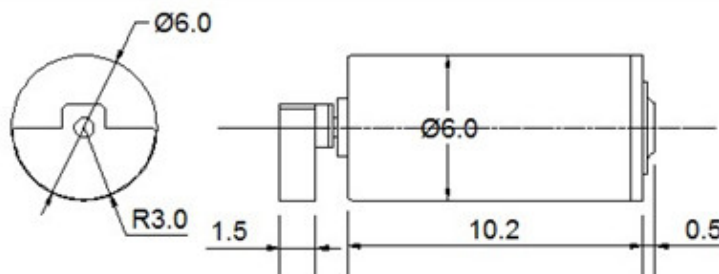
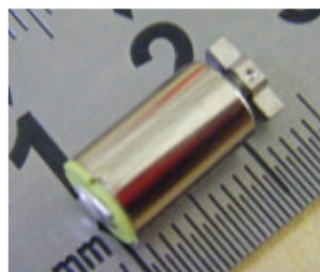

610 Series / 610系列	Model/型號	001	002	003	004	005	006	007
--------------------	----------	-----	-----	-----	-----	-----	-----	-----

Motor data (25°C)/ 運行參數 (25°C)

1 Rated voltage/額定電壓	V	1.3	1.5	1.5	3.0	3.0		
2 Range of application/使用範圍	V	1.2-1.8	1.2-1.8	1.2-1.8	2-3.6	2-3.6		
3 Starting voltage/起動電壓	V	0.8	0.8	0.8	1.4	1.4		
4 Rated speed/額定轉速 ±12%	rpm	10,500	11,500	10,000	12,500	15,000		
5 Rated current/額定電流 ≤150%	mA	40	50	50	40	65		
6 Terminal resistance/端電阻 ±20%	Ohm	10.5	11.0	10.0	31.5	21.0		
7 Starting current/起動電流	mA	124	136	150	95	143		
8 Vibrator specifications/振子規格	mA	R3*1.5	R2.5*2.4	R3.0*2.5	R3*1.5	R2.5*2.4		
9 Weight of motor/電機重量	g	1.6	1.8	2.1	1.6	1.8		

Additional information/其它相關信息

- Axial play/軸向間隙 0.05~0.30 mm
- Ambient temperature range/環境溫度範圍 -20~+65°C
- Motor parameters can be made according to the request of customer/馬達參數可根據客人要求制作
- Options:Vibrator specifications/其它可選項：振子規格

Motor typical application/馬達典型用途



Hairdressing health care products/美容保健品



Electronic products
電子產品



Electric toys
電動玩具



Z. X. D TECHNOLOGY CO., LTD

Add: No 8, South 2nd Road Xinfu, Xinqiao, Shajing Town, Shenzhen City, China

Tel: 86-755-33509305-802

Fax: 86-755-23086306

Website: <http://www.zxd-motor.com>

Email: jeff@zxd-motor.com