

DC coreless motor 6mm / 直流空心杯馬達 6mm

Ø6mm, metal brushes/Ø6mm, 金屬電刷

Outline Drawing/外形圖

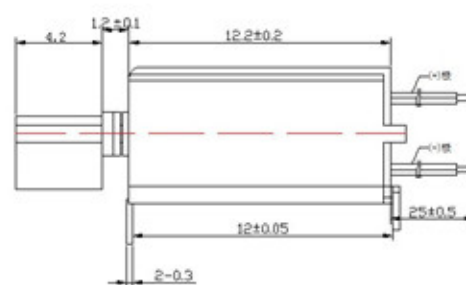
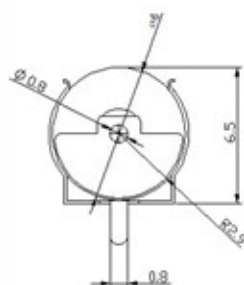
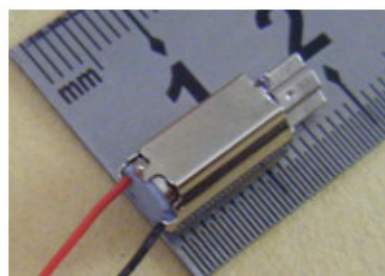

612 Series / 612系列	Model/型號	001	002	003	004	005	006	007
Motor data (25°C) / 運行參數 (25°C)								
1 Rated voltage/額定電壓	V	1.5	1.5	3.0	3.0			
2 Range of application/使用範圍	V	1.2-1.8	1.2-1.8	2.0-3.6	2.0-3.6			
3 Starting voltage/起動電壓	V	0.8	0.8	1.4	1.4			
4 Rated speed/額定轉速 ±12%	rpm	10,000	9,000	10,500	9,000			
5 Rated current/額定電流 ≤150%	mA	65	65	55	70			
6 Terminal resistance/端電阻 ±20%	Ohm	10.5	8.8	27.5	27.5			
7 Starting current/起動電流	mA	143	170	109	109			
8 Vibrator specifications/振子規格	mm	R2.5*4	R3*3.5	R2.5*4	R3*3.5			
9 Weight of motor/電機重量	g	2.2	2.3	2.2	2.3			

Additional information/其它相關信息

- Axial play/軸向間隙 0.05~0.30 mm
- Ambient temperature range/環境溫度範圍 -20~+65°C
- Motor parameters can be made according to the request of customer/馬達參數可根據客人要求制作
- Options: Vibrator specifications, leadwire length, /其它可選項: 振子規格, 引線長度,

Motor typical application/馬達典型用途

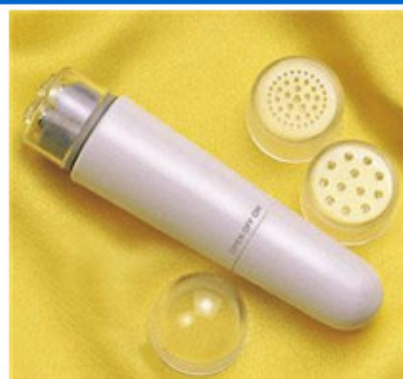

hairdressing health care products / 美容保健品



electric toothbrush
電動牙刷



electric toys
電動玩具



Z. X. D Technology Company Limited

Add: Shuibian Industrial Area, Hengli Town, Dongguan City, China

Tel: 86-769-82927257, ext: 611, 613

Website: <http://www.zxd-motor.com>

Fax: 86-769-82927259

Email: jeff@zxd-motor.com